

Northern Telecom Practice: 502-9001-200

Date: Dec. 2nd, 1974

**Product: Antique / Decorator Telephone Sets
QSK400 and QSK2400 Type
Cradlephone & Chestphone**

**Purpose: Identification, Connection
& Maintenance**

OCR: Yes

ANTIQUE/DECORATOR TELEPHONE SETS**QSK400- AND QSK2400-TYPE****CRADLEPHONE AND CHESTPHONE****IDENTIFICATION, CONNECTION, AND MAINTENANCE****Fig. 1 — QSK400A Cradlephone**

CONTENTS	PAGE	
1. GENERAL	1011	1. GENERAL
REASON FOR REISSUE	1012	1.01 This section provides identification, connection, and maintenance information for the QSK400- and QSK2400-type antique/decorator telephone sets.
2. IDENTIFICATION	1012	1.02 The antique/decorator telephone sets are available in two basic designs, the cradlephone and the chestphone.
3. CONNECTIONS	1013	
4. MAINTENANCE	1022	
5. ASSEMBLY OF PARTS	1034	
6. PACKING	1038	

1.03 The cradlephone is available only with a rotary dial. It has a rectangular base which contains the rotary dial. The handset cradle extends approximately six inches above the base. The cradlephone is similar in appearance to the antique French-style telephone. (See Fig. 1.)

1.04 The chestphone is similar in appearance to a rectangular jewel box. It has a hinged lid which is open when the telephone set is in use. The handset and dial are concealed when the lid is closed. The rotary dial chestphone is shown in Fig. 2 and the DIGITONE* dial chestphone is shown in Fig. 3.

1.05 The QSK400- and QSK2400-type telephone sets consist of a QSK10D telephone set (kit) assembled in an antique/decorator housing shell.

REASON FOR REISSUE

1.06 This section is reissued to revise Tables G, K, and H, which now include identification of additional parts and to include packing information and related illustrations (Fig. 17 and 18).

2. IDENTIFICATION

2.01 The QSK400- and QSK2400-type telephone set codes and their description are listed in Table A.

2.02 These telephone sets are supplied with a 3-conductor mounting cord. If the telephone set is used with NE-1A1, NE-1A2 Key Telephone Systems (KTS) or NE-3 type speakerphone systems see Table B for mounting cords.



Fig. 2 — QSK409A Chestphone

*Trademark of Northern Telecom Limited



Fig. 3 — QSK2408A Chestphone

2.03 The QSK400-type telephone set is a single line, rotary dial telephone set which is factory wired for residential use (Fig. 4). The set can also be modified for use with NE-1A1 or NE-1A2 KTS and NE-3 type speakerphone systems. (Table C and Fig. 5.)

2.04 The QSK2400-type telephone set is a single line DIGITONE dial telephone set which is factory wired for residential use (Fig. 6). The set can also be modified for use with NE-1A1 or NE-1A2 KTS and NE-3 type speakerphone systems. (Table D and Fig. 7.)

2.05 Field replaceable components are listed in Table E.

3. CONNECTIONS

3.01 Connections for the QSK400-type telephone sets are shown in Fig. 4 and 5 and for the QSK2400-type in Fig. 6 and 7.

3.02 A 4-conductor, NE-D4BJ mounting cord is required to provide A lead control for use with NE-1A1 or NE-1A2 KTS, and an NE-D10H mounting cord is required for use with NE-1A1 or NE-1A2 KTS and NE-3 type speakerphone systems.

3.03 The QSK400-type chestphones cannot be equipped with an extra length handset cord, due to its particular design.

3.04 Connections for all classes of residential service are shown in Table F.

3.05 The ringer volume control has a ringer cutoff position which is obstructed by a blocking screw. To provide the ringer cutoff feature, remove the bottom cover plate (Chart 1) and then remove the blocking screw from the underside of the ringer through the access hole in the telephone set base assembly.

TABLE A
QSK400- AND QSK2400-TYPE TELEPHONE SET CODES AND DESCRIPTION

CODE	DESCRIPTION
QSK400A	TELEPHONE SET, ANTIQUE GOLD, CRADLEPHONE
QSK401A	TELEPHONE SET, HERITAGE, CRADLEPHONE
QSK402A	TELEPHONE SET, ANTIQUE WHITE, CRADLEPHONE
QSK403A	TELEPHONE SET, MEDITERRANEAN, CRADLEPHONE
QSK404A <input type="checkbox"/>	TELEPHONE SET, BROCADE (RED ON ROSE), CRADLEPHONE
QSK405A <input type="checkbox"/>	TELEPHONE SET, BROCADE (GREEN ON BLUE), CRADLEPHONE
QSK406A <input type="checkbox"/>	TELEPHONE SET, BROCADE (GOLD ON SAND), CRADLEPHONE
QSK407A <input type="checkbox"/>	TELEPHONE SET, BLUE CAMEO, CRADLEPHONE
QSK408A	TELEPHONE SET, CARVED WALNUT, CHESTPHONE (ROTARY DIAL)
QSK409A	TELEPHONE SET, BLACK LEATHER, CHESTPHONE (ROTARY DIAL)
QSK410A <input type="checkbox"/>	TELEPHONE SET, HUNTING SCENE, CHESTPHONE (ROTARY DIAL)
QSK2408A	TELEPHONE SET, CARVED WALNUT, CHESTPHONE (DIGITONE DIAL)
QSK2409A	TELEPHONE SET, BLACK LEATHER CHESTPHONE (DIGITONE DIAL)
QSK2410A <input type="checkbox"/>	TELEPHONE SET, HUNTING SCENE, CHESTPHONE (DIGITONE DIAL)

TABLE B
ASSOCIATED APPARATUS (To be ordered separately if required)

TELEPHONE SET CODE	MOUNTING CORD	
	NE-1A1 OR NE-1A2 KEY TELEPHONE SYSTEM	NE-1A1 OR NE-1A2 KEY TELEPHONE SYSTEM AND NE-3 TYPE SPEAKERPHONE
QSK400A	NE-D4BJ-20	NE-D10H-20
QSK401A	NE-D4BJ-3	NE-D10H-3
QSK402A	NE-D4BJ-20	NE-D10H-20
QSK403A	NE-D4BJ-3	NE-D10H-3
QSK404A, 405A, 406A <input type="checkbox"/>	NE-D4BJ-20	NE-D10H-20
QSK407A <input type="checkbox"/>	NE-D4BJ-20	NE-D10H-20
QSK408A, 2408A	NE-D4BJ-60	NE-D10H-60
QSK409A, 2409A	NE-D4BJ-3	NE-D10H-3
QSK410A, 2410A <input type="checkbox"/>	NE-D4BJ-60	NE-D10H-60

☐ Not Bell Canada

TABLE C
QSK400-TYPE TELEPHONE SET CONVERSION
NE-1A1, NE-1A2 KTS, and NE-3 TYPE SPEAKERPHONE
(Note 1 and 2)

WIRE OR LEAD	COLOR	REMOVE FROM NETWORK TERMINAL	CONNECT TO NETWORK TERMINAL	
			NE-1A1 OR NE-1A2 KTS	NE-3 TYPE SPEAKERPHONE WITH NE-1A1 OR NE-1A2 KTS (Note 2)
LINE SWITCH	S-BR S-W S	C F K	G1 C (Note 5)	G1 C (Note 3)
RINGER	BK	G1	F (Note 4)	F (Note 4)
NE-M1W CORD OR EQUIVALENT			STRAP K TO 2L	

Notes:

1. For NE-1A1 or NE-1A2 KTS only, use an NE-D4BJ mounting cord. For NE-1A1 or NE-1A2 KTS and NE-3 type speakerphone systems use an NE-D10H mounting cord and connect as shown in Fig. 5.
2. The telephone set may be dialed in the on-hook position with the speakerphone option.
3. Use a QCM12A connector to connect the slate (S) line switch lead to the LK lead from the speakerphone transmitter unit.
4. Use QCM15A connectors when additional quick-connect positions are required.
5. Insulate and store.

TABLE D
QSK2400-TYPE TELEPHONE SET CONVERSION
NE-1A1, NE-1A2 KTS, AND NE-3 TYPE SPEAKERPHONE
(NOTES 1 AND 2).

WIRE OR LEAD	COLOR	REMOVE FROM NETWORK TERMINAL	CONNECT TO NETWORK TERMINAL	
			NE-1A1 OR NE-1A2 KTS	NE-3 TYPE SPEAKERPHONE WITH NE-1A1 OR NE-1A2 KTS (Note 2)
LINE SWITCH	S-BR S-W S	C RR K	G1 C (Note 5)	G1 C (Note 3)
RINGER	BK	G1	RR (Note 4)	RR (Note 4)
NE-M1W CORD OR EQUIVALENT			STRAP K TO 2L	

Notes;

1. For NE-1A1 or NE-1A2 KTS only, use an NE-D4BJ mounting cord. For NE-1A1 or NE-1A2 KTS and NE-3 type speakerphone systems use an NE-D10H mounting cord and connect as shown in Fig. 7.
2. The telephone set may be dialed in the on-hook position with the speakerphone option.
3. Use a QCM12A connector to connect the slate (S) line switch lead to the LK lead from the speakerphone transmitter unit.
4. Use QCM15A connectors when additional quick-connect positions are required.
5. Insulate and store.

TABLE E
FIELD REPLACEABLE COMPONENTS

PART NO.	ITEM
NE-D3BN*	Mounting Cord
NE-H4QM*	Handset Cord
NE-6QC	Dial (Chrome)
NE-6QD	Dial (Gold)
NE-35Q3L1	Dial (DIGITONE)
NE-M1A	Ringer
NE-U1	Receiver Unit
NE-T1	Transmitter Unit
*Specify color -3 (black) -20 (white) -60 (light beige)	

TABLE F
LINE AND RINGER CONNECTIONS

WIRE OR LEAD	COLOR	INDIVIDUAL OR BRIDGED	RING PARTY	TIP PARTY NO IDENTIFICATION TO GROUND	TIP PARTY IDENTIFICATION TO GROUND	
					1000 Ω	2650 Ω
Line wire at connecting block	R G Y	R G Y	R G Y	R G Y	R G Y	R G Y
Mounting cord at connecting block	R G Y	R G G	R G Y	G R Y	G R Y	G R Y
Ringer lead at QNB18C network	R S-R S BK	A (Note) * * G1	A (Note) * * G1	A (Note) * * G1	A (Note) * B G1	A (Note) B * G1
* Insulated and stored Note: To permanently silence ringer remove the red (R) ringer lead from network terminal A and insulate and store.						

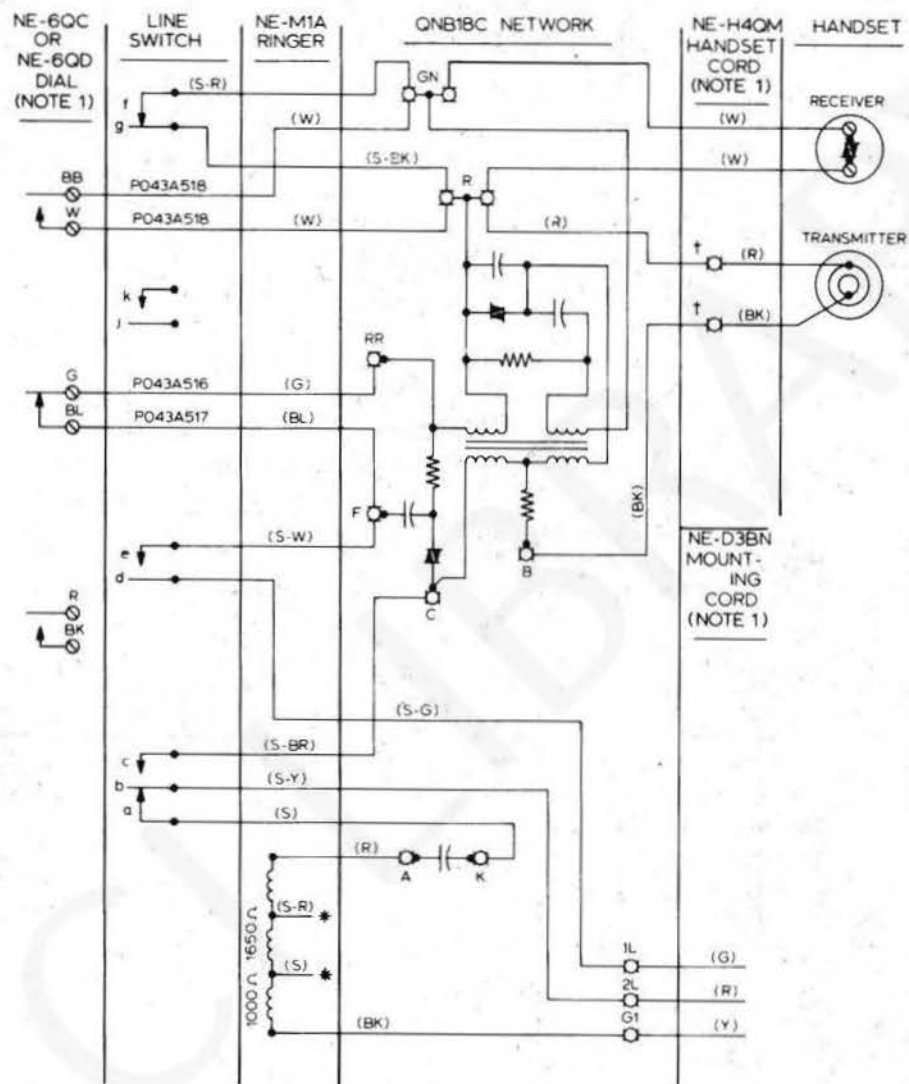

NOTES

- 1 THESE PARTS ARE NOT SUPPLIED WITH QSK10D TELEPHONE SETS AND MUST BE ORDERED SEPARATELY
- * INSULATED AND STORED
- † QCM12A CONNECTOR

Fig. 4 — QSK400-Type Telephone Set — Connections

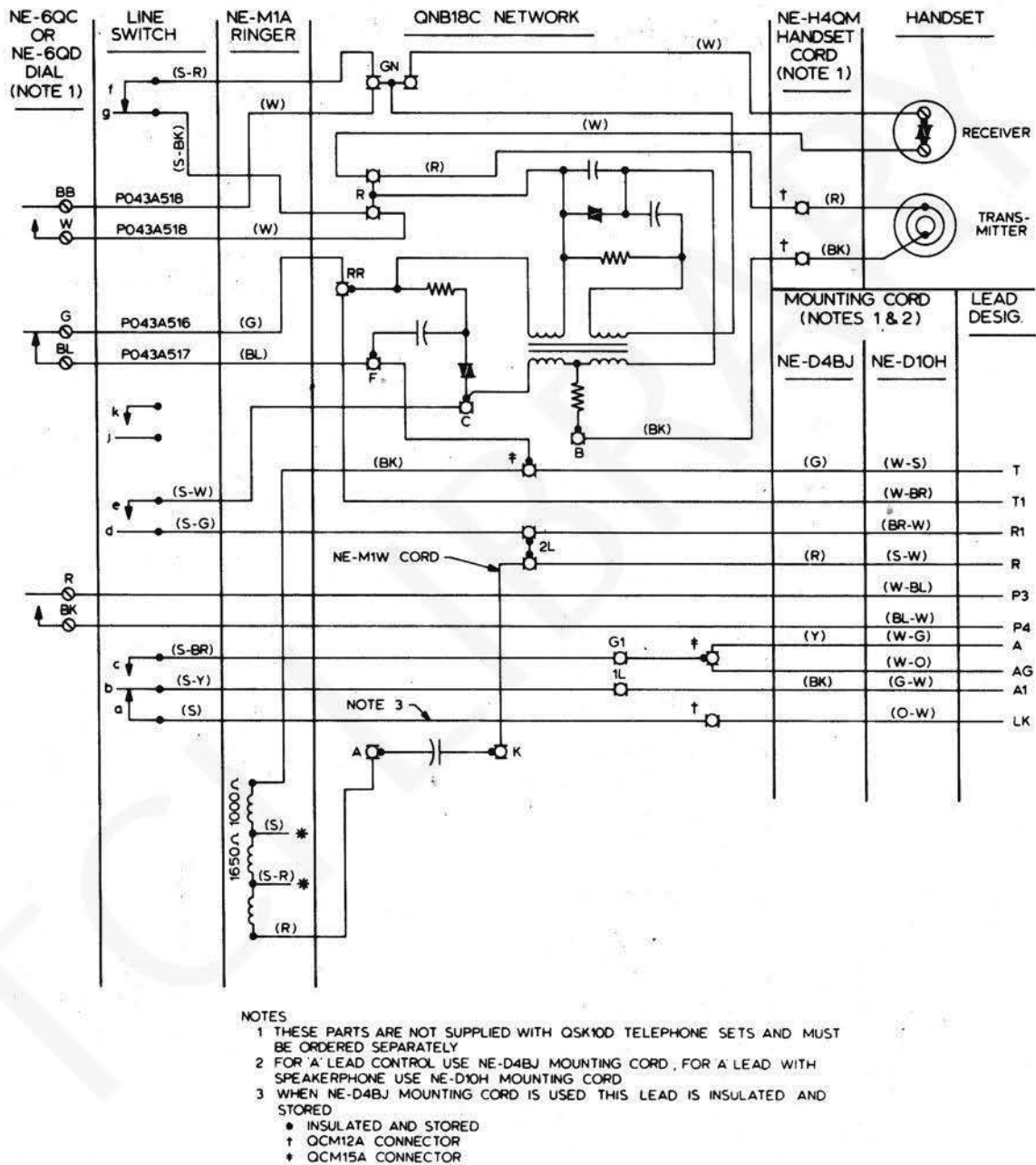

Fig. 5 – QSK400-Type Telephone Set – Connections
NE-1A1, NE-1A2 KTS and NE-3 Type Speakerphone Systems

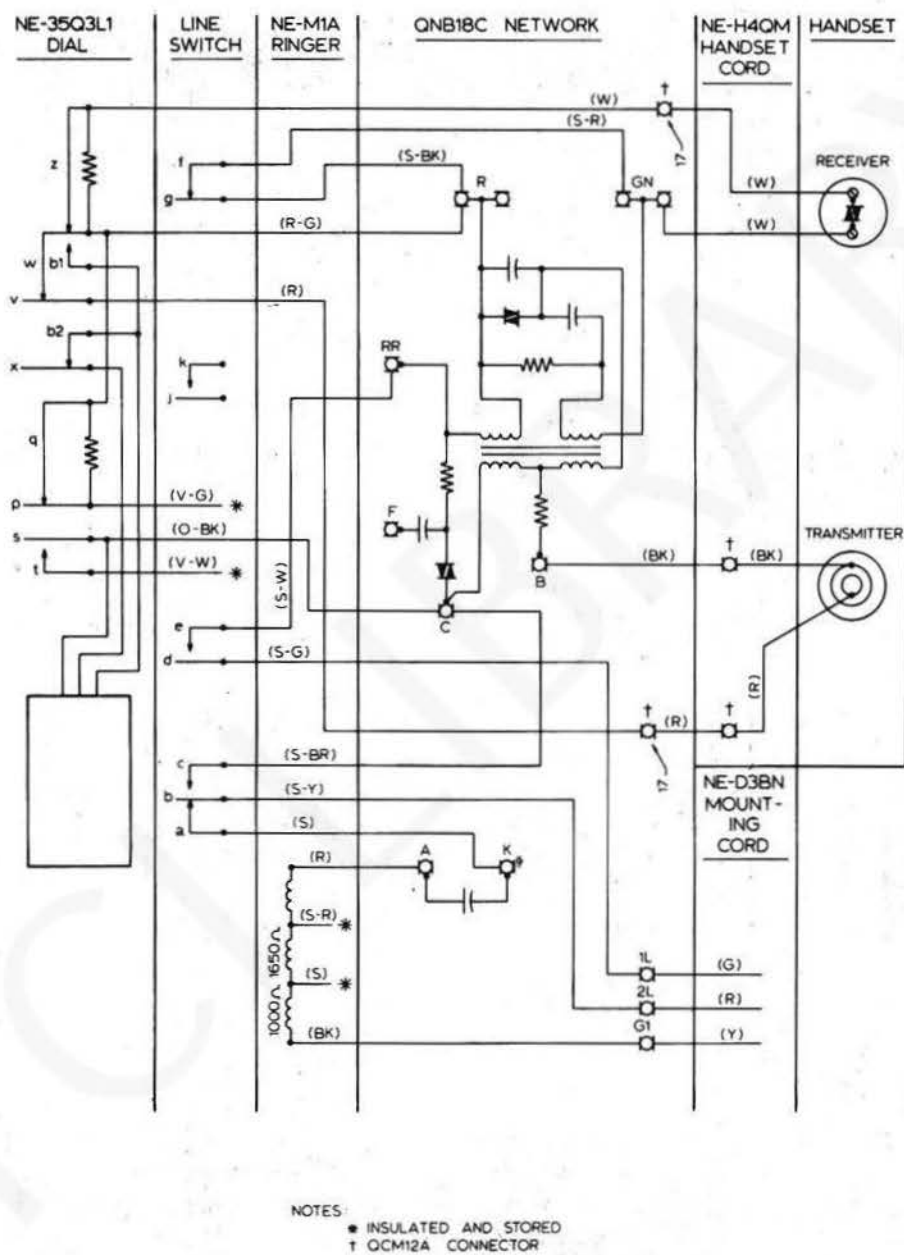
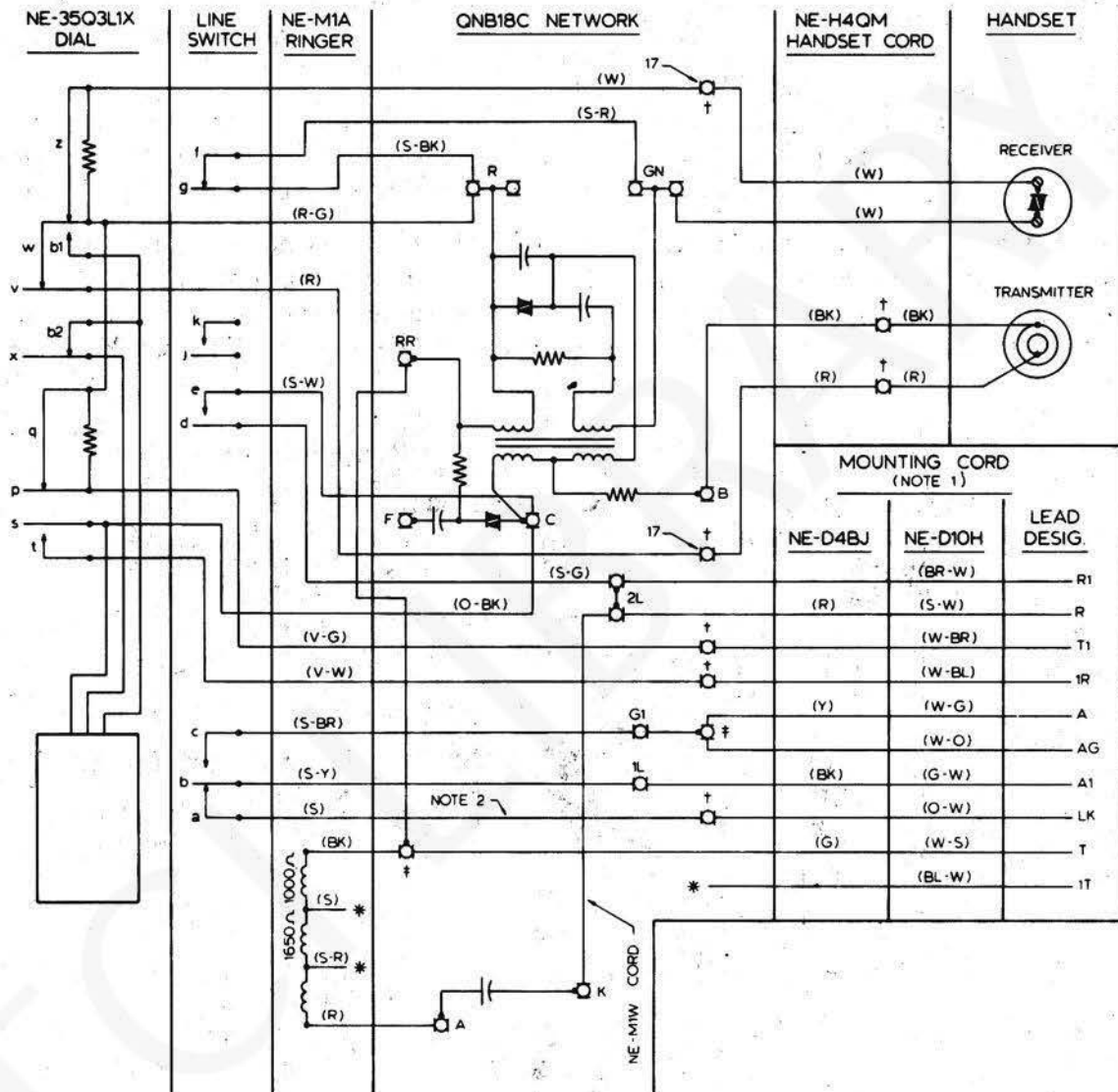

Fig. 6 – QSK2400-Type Telephone Set – Connections



NOTES

- 1 FOR A LEAD CONTROL USE NE-D4BJ MOUNTING CORD. FOR A LEAD WITH SPEAKERPHONE USE NE-D10H MOUNTING CORD
- 2 WHEN NE-D4BJ MOUNTING CORD IS USED THIS LEAD IS INSULATED AND STORED
- INSULATED AND STORED
- † QCM12A CONNECTOR ‡ QCM15A CONNECTOR

Fig. 7 — QSK2400-Type Telephone Set — Connections
NE-1A1, NE-1A2 KTS, and NE-3 Type Speakerphone Systems

4. MAINTENANCE

4.01 Field maintenance of the QSK400- and QSK2400-type telephone sets is limited to those components listed in Table E.

4.02 Maintenance of the antique/decorator housings should not be done in the field. If the antique/decorator housing is damaged, replace the complete telephone set.

4.03 For maintenance information concerning dial, ringer, etc., refer to the appropriate section on the component.

4.04 Assembly of parts information is shown in Fig. 8 through 15 while parts identification is listed in Tables G through N.

4.05 For assembly and part identification information for the PO522709 telephone set base assembly refer to the appropriate section on the QSK10D telephone set (kit).

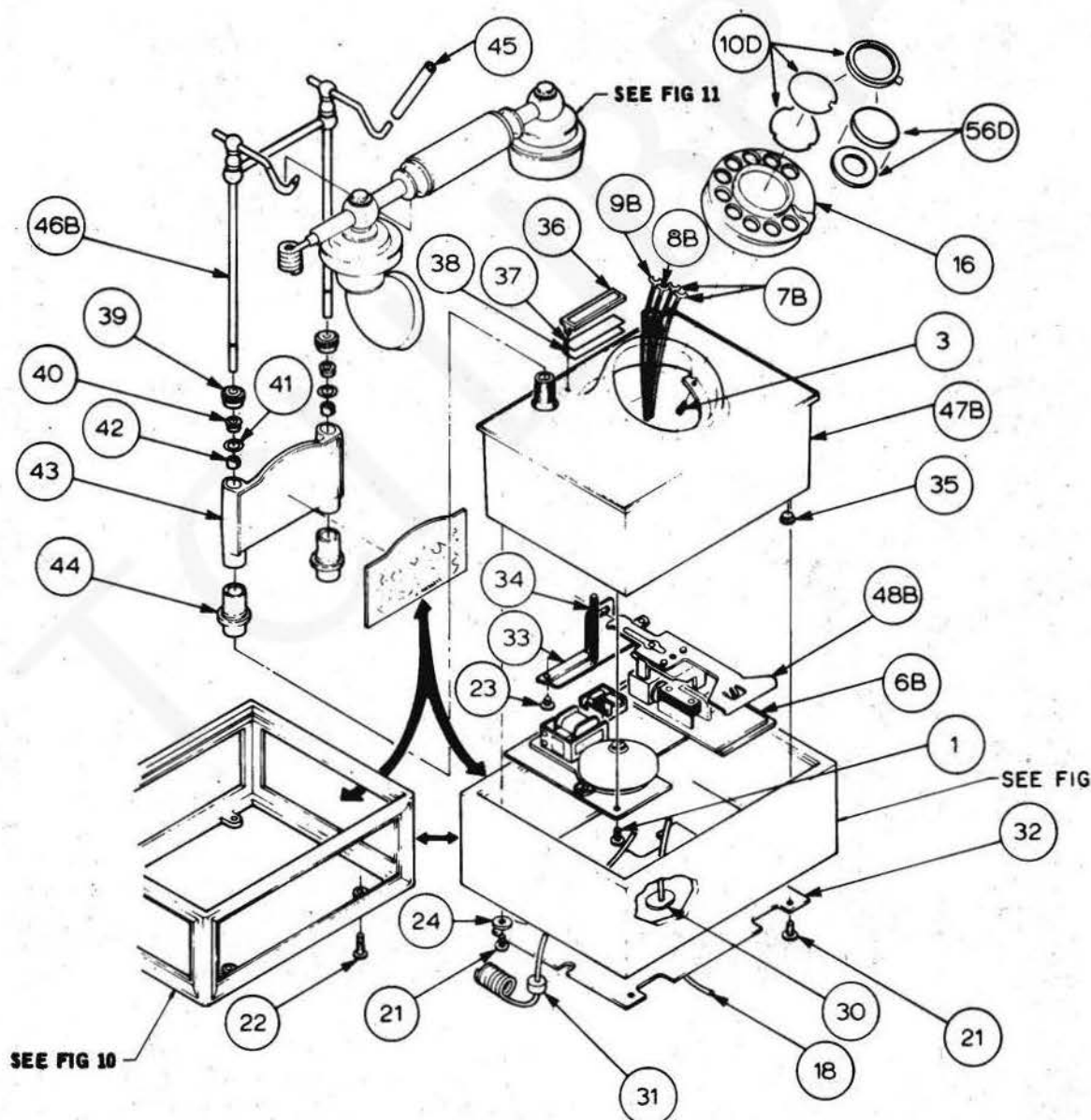

Fig. 8 — QSK400-Type Cradlephone — Assembly of Parts (Table G)

TABLE G □
IDENTIFICATION OF PARTS – QSK400-TYPE CRADLEPHONE

ITEM NO. (FIG. 8)	IDENTIFICATION		DESCRIPTION	QSK400A	QSK401A	QSK402A	QSK403A	QSK404A	QSK405A	QSK406A	QSK407A
	NE PART NO.	DECO-TEL PART NO.									
1	P0180924	—	0.112-40 (4-40) x 5/16 in. long pan head machine screw	4	4	4	4	4	4	4	4
3	P0125035	—	0.112-36 (4-36) x 5/16 in. long pan head machine screw	3	3	3	3	3	3	3	3
6B	P0522709	—	Base Assembly, Telephone Set	1	1	1	1	1	1	1	1
7B	P043A516	—	Lead Assembly, (Note 1)	2	2	2	2	2	2	2	2
8B	P043A517	—	Lead Assembly, (Note 1)	1	1	1	1	1	1	1	1
9B	P043A516	—	Lead Assembly, (Note 1)	1	1	1	1	1	1	1	1
10D	P0896341	—	Card Holder Parts Group (Note 2)	1	1	1	1	1	1	1	1
16	NE-6QD	—	Dial (Note 2)	1	1	1	1	1	1	1	1
18	NE-D3BN-20	—	Mounting Cord (Warm White)	1		1		1	1	1	1
	NE-D3BN-3	—	Mounting Cord (Black)		1		1				
21	C0038069	7136	Screw, Slotted, HWH 7-19 Hi-Lo thd, x 3/8 in. long	4	8	8	8	4	4	4	4
22	C0038070	7137	Screw, Phillips, PH, 7-19 Hi-Lo thd, x 3/8 in. long	4				4	4	4	4
23	C0038071	7127	Screw, Phillips, PHMS, 0.112-40 (4-40) x 1/4 in. long	2	2	2	2	2	2	2	2
24	C0038072	7111	Washer, Flat, No. 10		4	4	4				
30	C0038073	7204	Grommet, Rubber	1	1	1	1	1	1	1	1
31	C0038074	7207	Grommet, Rubber	1	1	1	1	1	1	1	1
32	C0038075	1155	Cover, Bottom	1	1	1	1	1	1	1	1
33	C0038076	1150	Spreader, Actuator	1	1	1	1	1	1	1	1
34	C0038077	1158	Spring, Actuator	1	1	1	1	1	1	1	1
35	C0038078	2212	Foot, Rubber	4	4	4	4	4	4	4	4
36	C0038079	1030-G	Holder, Number Card (Gold)	1	1	1	1	1	1	1	1
37	C0038080	1031	Window, Number Card	1	1	1	1	1	1	1	1
38	C0038081	1018	Card, Number	1	1	1	1	1	1	1	1
39	C0038082	1006	Nut, Hanger Guide	2	2	2	2	2	2	2	2
40	C0038083	1063	Bushing, Hanger Guide Nut	2	2	2	2	2	2	2	2
41	C0038084	7205	O-Ring, 0.41 in. ID x 0.059 in. dia.	2	2	2	2	2	2	2	2
42	C0038085	1064	Grommet, Actuator Rod	2	2	2	2	2	2	2	2
43	C0038086	1032-W	Bracket (White)	1		1		1	1	1	1
	C0038087	1032-B	Bracket (Black)		1		1				
44	C0038088	1007	Sleeve, Guide	2	2	2	2	2	2	2	2
45	C0038089	2204	Sleeve, Vinyl	2	2	2	2	2	2	2	2
46B	C0038090	1008-4	Hanger Assembly	1	1	1	1	1	1	1	1
47B	C0038091	1180-W	Base and Dial Plate Assembly (White)	1		1		1	1	1	1
	C0038092	1180-B	Base and Dial Plate Assembly (Black)		1		1				
48B	C0038093	1156	Actuator Assembly	1	1	1	1	1	1	1	
56D	C0039130	4215-W	Dial Insert and Sponge (White)			1		1	1	1	
	C0039131	4215-B	Dial Insert and Sponge (Black)		1		1				
	C0039132	4215-G	Dial Insert and Sponge (Gold Figure)	1							
	C0039129	4215-C	Dial Insert and Sponge (Cameo)								1

Notes:

- Items 7B, 8B, and 9B are shown on Fig. 4 and 5.
- Item 10D is shipped with each dial (Item 16) when ordered for replacement purposes.

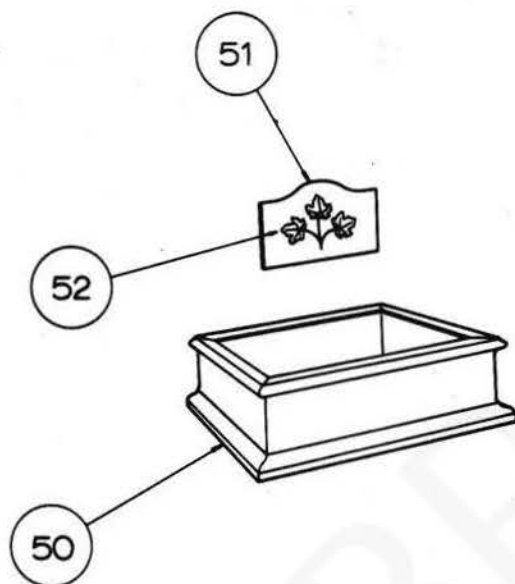

Fig. 9 – Cradlephone Decorative Enclosure (Table H)

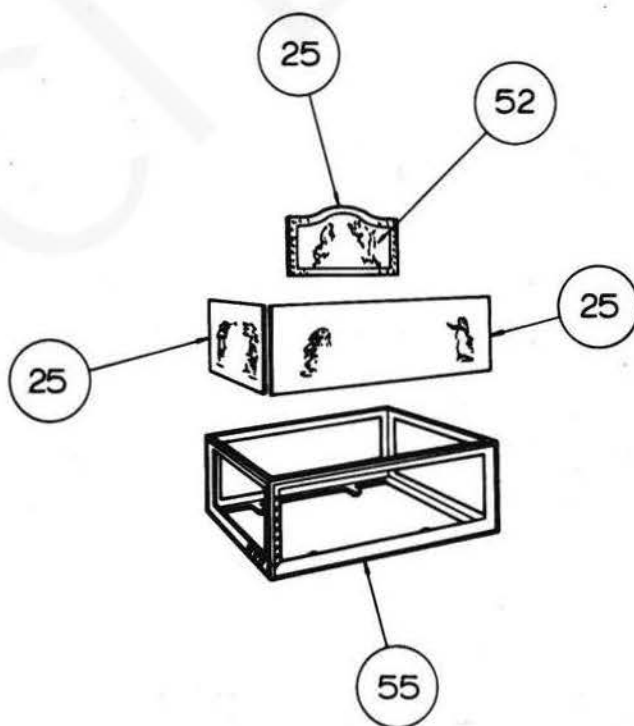

Fig. 10 – Cradlephone Decorative Modular Frame (Table I)

TABLE H □
IDENTIFICATION OF PARTS – DECORATIVE ENCLOSURE

ITEM NO. (FIG. 9)	IDENTIFICATION		DESCRIPTION	QSK401A	QSK402A	QSK403A
	NE PART NO.	DECO-TEL PART NO.				
50	C0038094	1310-1	Base	1		
	C0038095	1320-1	Base		1	
	C0038096	1330-1	Base			1
51	C0038097	1310-2	Insert	1		
	C0038098	1320-2	Insert		1	
	C0038099	1330-2	Insert			1
52	C0038374	1310-4	Insignia	1		
	C0038302	1320-3	Insignia		1	
	C0038303	1330-3	Insignia			1

TABLE I □
IDENTIFICATION OF PARTS – DECORATIVE MODULAR FRAME

ITEM NO. (FIG. 10)	IDENTIFICATION		DESCRIPTION	QSK400A	QSK404A	QSK405A	QSK406A	QSK407A
	NE PART NO.	DECO – TEL PART NO.						
25	C0038363	2215	Panel Set	1				
	C0038364	1440-1	Panel Set		1			
	C0038365	1441-1	Panel Set			1		
	C0038366	1442-1	Panel Set				1	
	C0038367	2214	Panel Set					1
52	C0038302	1320-3	Insignia		1	1	1	
55	C0038306	1145-G	Frame (Gold)	1	1	1	1	
	C0038307	1145-W	Frame (White)					1

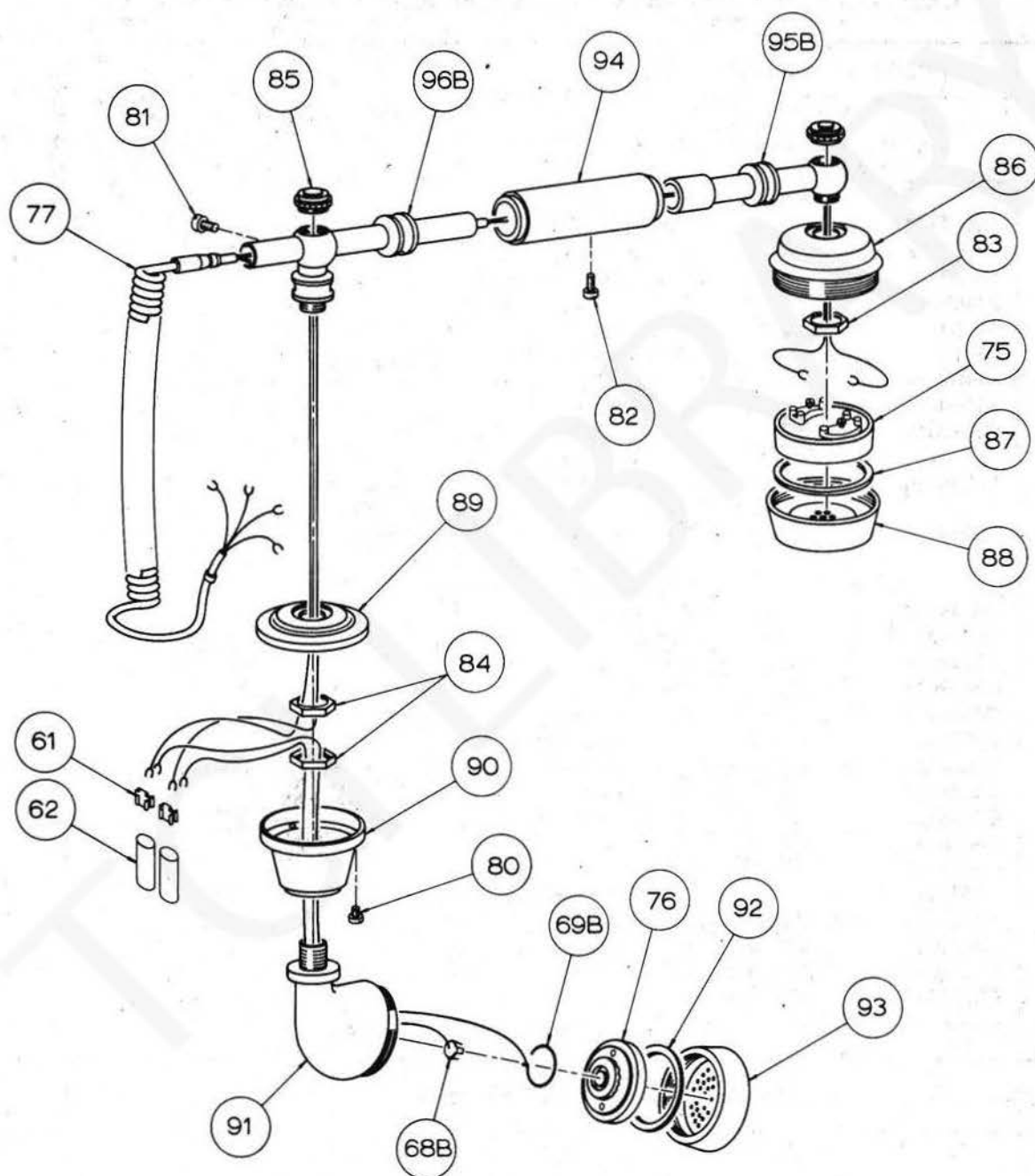

Fig. 11 — Cradlephone Handset — Assembly of Parts (Table J)

TABLE J □
IDENTIFICATION OF PARTS – CRADLEPHONE HANDSET ASSEMBLY

ITEM NO. (FIG. 11)	IDENTIFICATION		DESCRIPTION	QSK400A	QSK401A	QSK402A	QSK403A	QSK404A	QSK405A	QSK406A	QSK407A
	NE PART NO.	DECO – TEL PART NO.									
61	P096B583	—	Connector (Note 1)	2	2	2	2	2	2	2	2
62	P0892878	—	Tubing (Note 1)	2	2	2	2	2	2	2	2
68B	P096B684	—	Spider and Lead Assembly	1	1	1	1	1	1	1	1
69B	P096B685	—	Bracket and Lead Assembly	1	1	1	1	1	1	1	1
75	NE-U1	—	Unit, Receiver	1	1	1	1	1	1	1	1
76	NE-T1	—	Unit, Transmitter	1	1	1	1	1	1	1	1
77	NE-H4QM-20	—	Cord, Handset (Warm White)	1		1		1	1	1	1
	NE-H4QM-3	—	Cord, Handset (Black)		1		1				
80	C0038019	7129	Screws, Fil HMS Slotted 0.112-40 (4-40) x 1/4 in. long brass	3	3	3	3	3	3	3	3
81	C0038020	7132	Screw, RHMS, Self-Tapping Type 0.164 No. 8 x 3/16 in. long gold plate	1	1	1	1	1	1	1	1
82	C0038021	7128	Screw, Fil HMS, Phillips and Slotted, Swage Form, 0.112 No. 4 x 5/16 in. long cad. plated steel	1	1	1	1	1	1	1	1
83	C0038022	7133	Palnut	1	1	1	1	1	1	1	1
84	C0038023	7130	Palnut	2	2	2	2	2	2	2	2
85	C0038024	1017	Nut	2	2	2	2	2	2	2	2
86	C0038025	1024	Shell, Receiver	1	1	1	1	1	1	1	1
87	C0038026	1065	Gasket, Receiver	1	1	1	1	1	1	1	1
88	C0038027	1025-B	Cap, Receiver (Black)		1		1				
	C0038028	1025-W	Cap, Receiver (White)	1		1		1		1	
89	C0038029	1014	Shell, Upper Transmitter	1	1	1	1	1	1	1	1
90	C0038030	1013	Shell, Lower Transmitter	1	1	1	1	1	1	1	1
91	C0038031	1011-B	Horn (Black)		1		1				
	C0038032	1011-W	Horn (White)	1		1		1	1	1	1
92	C0038033	1052	Gasket, Transmitter	1	1	1	1	1	1	1	1
93	C0038034	1012	Cap, Transmitter	1	1	1	1	1	1	1	1
94	C0038035	1021-B	Handle (Black)		1		1				
	C0038036	1021-W	Handle (White)	1		1		1		1	
95B	C0038037	1022	Tube Assembly	1	1	1	1	1	1	1	1
96B	C0038038	1019	Tube Assembly	1	1	1	1	1	1	1	1

Note: These items are part of the QCM12A Connector.

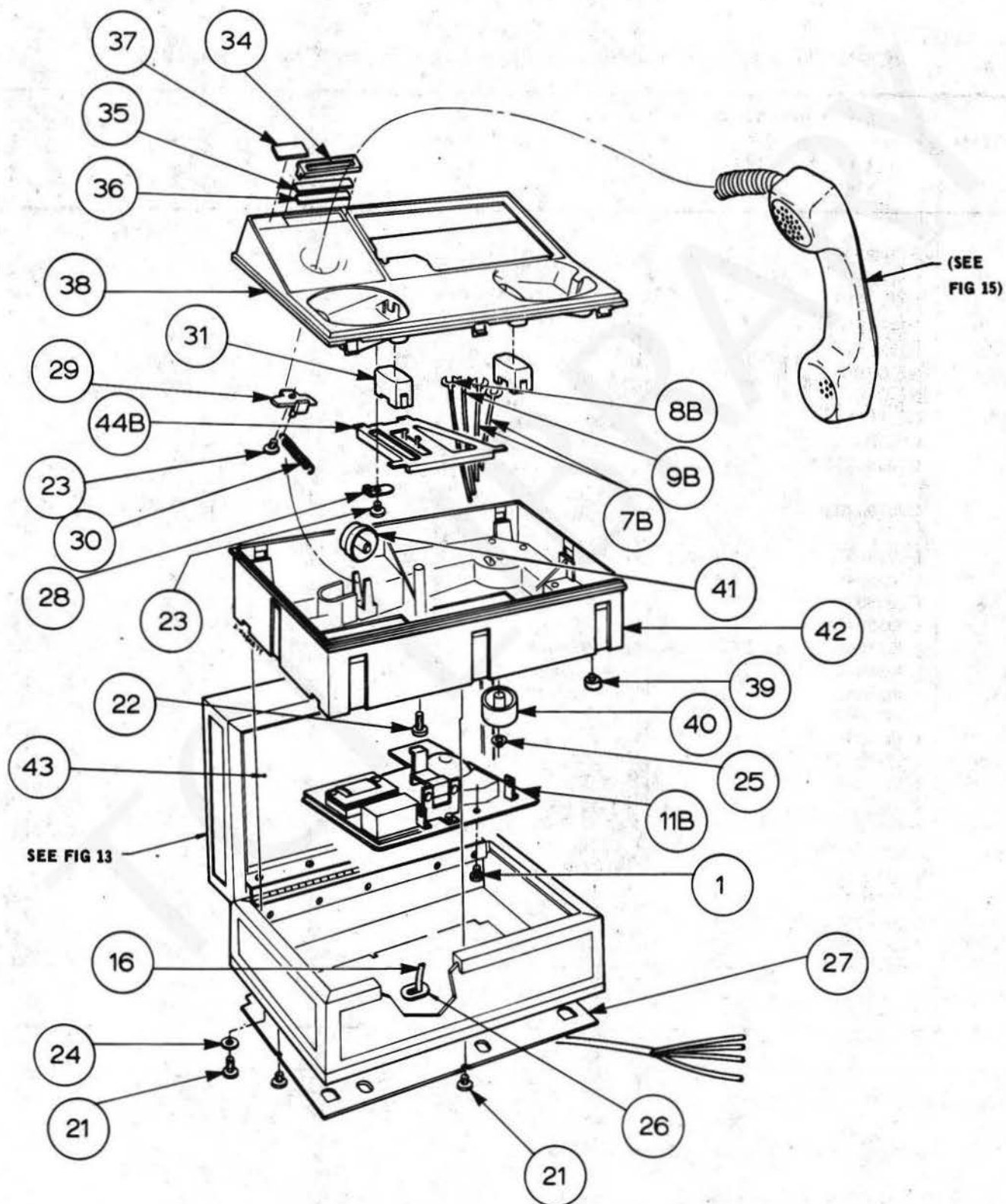

Fig. 12 — QSK400- and QSK2400-Type Chestphone
Assembly of Parts (Table K)

TABLE K □
IDENTIFICATION OF PARTS – QSK400- AND QSK2400-TYPE CHESTPHONE

ITEM NO. (FIG. 12)	IDENTIFICATION		DESCRIPTION	QSK408A	QSK409A	QSK410A	QSK2408A	QSK2409A	QSK2410A
	NE PART NO.	DECO – TEL PART NO.							
1	P0180924	—	Screw, PHMS 0.112-40 (4-40) x 5/16 in. long	4	4	4	4	4	4
7B	P043A518	—	Lead Assembly (Note 1)	2	2	2			
8B	P043A517	—	Lead Assembly (Note 1)	1	1	1			
9B	P043A516	—	Lead Assembly (Note 1)	1	1	1			
11B	P0522709	—	Base Assembly	1	1	1	1	1	1
16	NE-D3BN-3	—	Cord, Mounting (Black)		1			1	
	NE-D3BN-60	—	Cord Mounting (Light Beige)	1		1	1		1
17	QCM12A	—	Connector (Note 2)				2	2	2
21	C0038069	7136	Screw, HWH, Slotted Hi-Lo thd. 7-19 x 3/8 long	11	11	11	8	8	8
22	C0038045	7112	Screw, FHWS, Phillips, Self Tapping No. 6 x 2 in. long	1	1	1	1	1	1
23	C0038070	7137	Screw, PH, Phillips, Hi-Lo thd. 7-19 x 3/8 in. long	3	3	3	3	3	3
24	C0038072	7111	Washer, Flat No. 10	4	4	4	4	4	4
25	C0038046	7124	Palnut	1		1	1	1	1
26	C0038073	7204	Grommet, Rubber	1	1	1	1	1	1
27	C0038047	2182	Cover, Bottom	1	1	1	1	1	1
28	C0038048	2172	Stop, Actuator	2	2	2	2	2	2
29	C0038049	2171	Lever, Stop Actuator	1	1	1	1	1	1
30	C0038050	2187	Spring, Actuator	1	1	1	1	1	1
31	C0038397	2105-B	Cap, Actuator (Black)		2			2	
	C0038398	2105-T	Cap, Actuator (Tan)	2		2	2		2
34	C0038054	1030	Holder, Number Card	1	1	1	1	1	1
35	C0038080	1031	Window, Number Card	1	1	1	1	1	1
36	C0038081	1018	Card, Number	1	1			1	1
37	P0527707	—	Label	1	1	1	1	1	1
38	C0038055	2102-B	Cover, Base (Black)		1			1	
	C0038056	2102-T	Cover, Base (Tan)	1		1	1		1
39	C0038078	2212	Foot, Rubber	4	4	4	4	4	4
40	C0038057	2017	Wheel, Cord	1	1	1	1	1	1
41	C0038058	2165	Wheel, Cord Outlet	1	1	1	1	1	1
42	C0038059	2101	Frame, Base	1	1	1	1	1	1
43	C0038060	2180-B	Liner (Black)		1			1	
	C0038061	2180-T	Liner (Tan)	1		1	1		1
44B	C0038321	2186	Lever Assembly, Actuator	1	1	1	1	1	1

Notes:

- Items 7B, 8B, and 9B are shown on Fig. 4 and 5.
- Item 17 is shown on Fig. 6 and 7.

TABLE L □
IDENTIFICATION OF PARTS – DECORATIVE CHEST

ITEM NO. (FIG. 13)	IDENTIFICATION		DESCRIPTION	QSK408A	QSK2408A	QSK409A	QSK2409A	QSK410A	QSK2410A
	NE PART NO.	DECO – TEL PART NO.							
50	C0038062	7106	Screw, FH, Slotted, Self-Tapping No. 6 x 3/8 in. long	10	10	10	10	10	10
51	C0038063	2178	Hinge	1	1	1	1	1	1
52	C0038065	2177-2131	Chest, Walnut			1	1		
	C0038064	2177-2110	Chest, Carved Walnut	1	1				
	C0038322	2177-2150	Chest					1	1
53	C0038323	2150-2	Plaque, Hunting Scene					1	1
57	C0038368	2131-2	Panel Set			1	1		

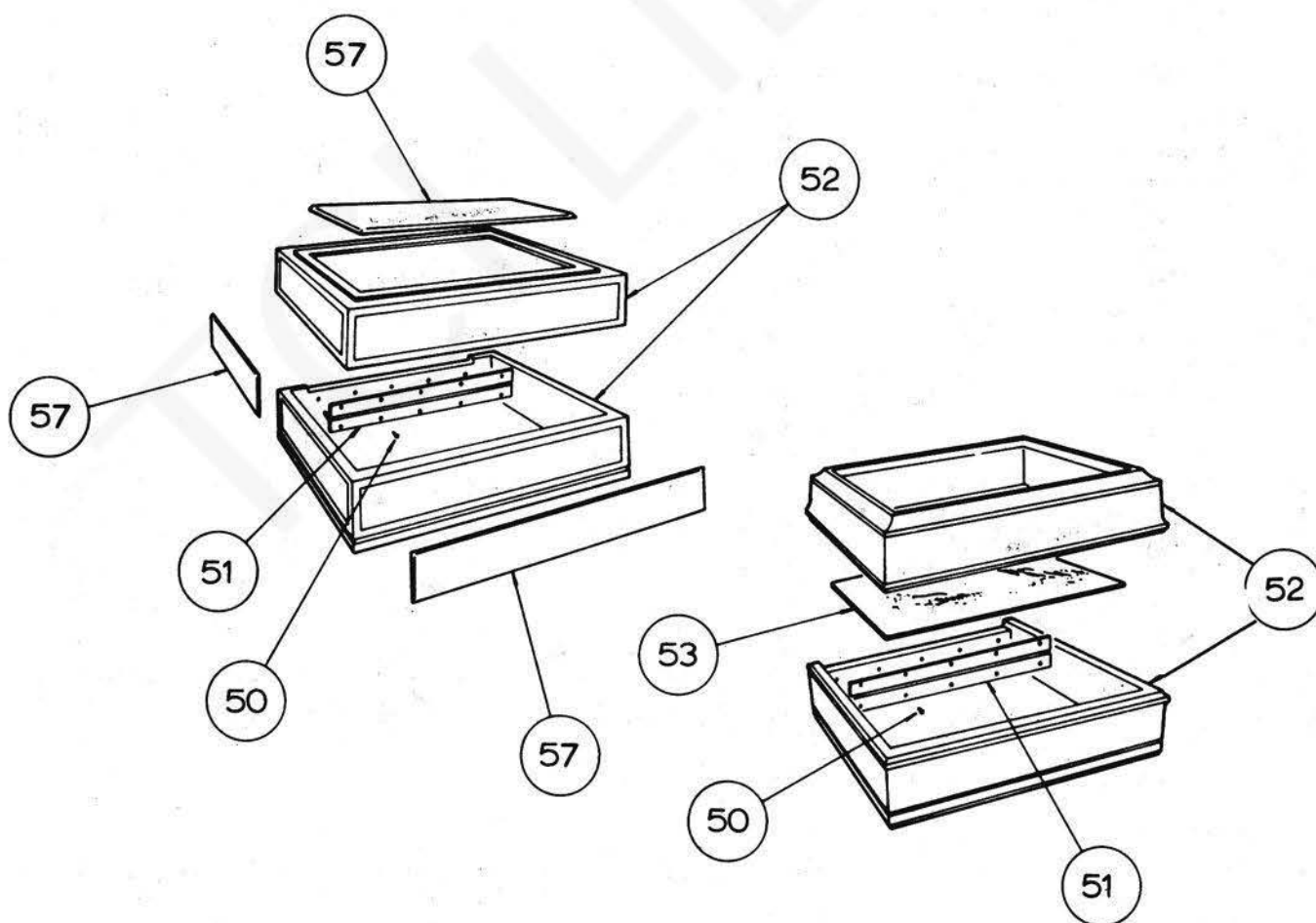

Fig. 13 – Decorative Chest – Assembly of Parts (Table L)

TABLE M □
IDENTIFICATION OF PARTS – QSK400- AND QSK2400-TYPE CHESTPHONE DIALS

ITEM NO. (FIG. 14)	IDENTIFICATION		DESCRIPTION	QSK408A	QSK409A	QSK410A	QSK2408A	QSK2409A	QSK2410A
	NE PART NO.	DECO – TEL PART NO.							
2	P0125035	—	Screw, PHMS 0.112-36 (4-36) x 5/16 in. long	3	3	3			
3	P0180922	—	Screw, PHMS 0.112-36 (4-36) x 3/16 in. long				4	4	4
10D	P043A354	—	Card Retainer Group*	1	1	1			
15	NE-6QC	—	Dial	1	1	1			
	NE-35Q3L1	—	DIGITONE Dial				1	1	1
21	C0038069	7136	Screw, HWH, Slotted Hi-Lo thd. 7-19 x 3/8 in. long	11	11	11	8	8	8
32	C0038052	2006-2	Insert, Number	1	1	1			
33	C0038053	2140	Plate, Dial Support	1	1	1			
38	C0038055	2102-B	Cover, Base (Black)		1			1	
	C0038056	2102-T	Cover, Base (Tan)	1		1			
45	C0038348	2173	Bracket				2	2	2
46	C0038346	2106-B	Plate Assembly (Black)					1	
	C0038347	2106-T	Plate Assembly (Tan)				1		1
60D	C0039128	4215-T	Dial Insert and Sponge (Tan)	1		1			
	C0039131	4215-B	Dial Insert and Sponge (Black)		1				

*Item 10D is shipped with each dial (Item 15) when ordered for replacement purposes.

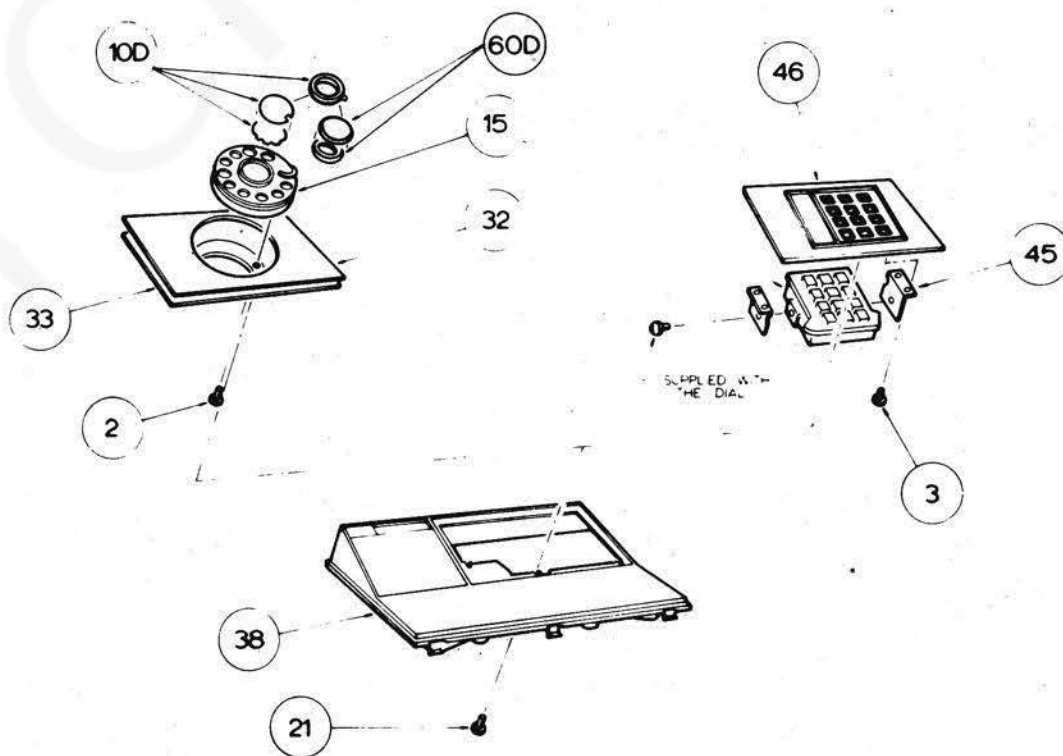

Fig. 14 – QSK400- and QSK2400-Type Chestphone – Dials (Table M)

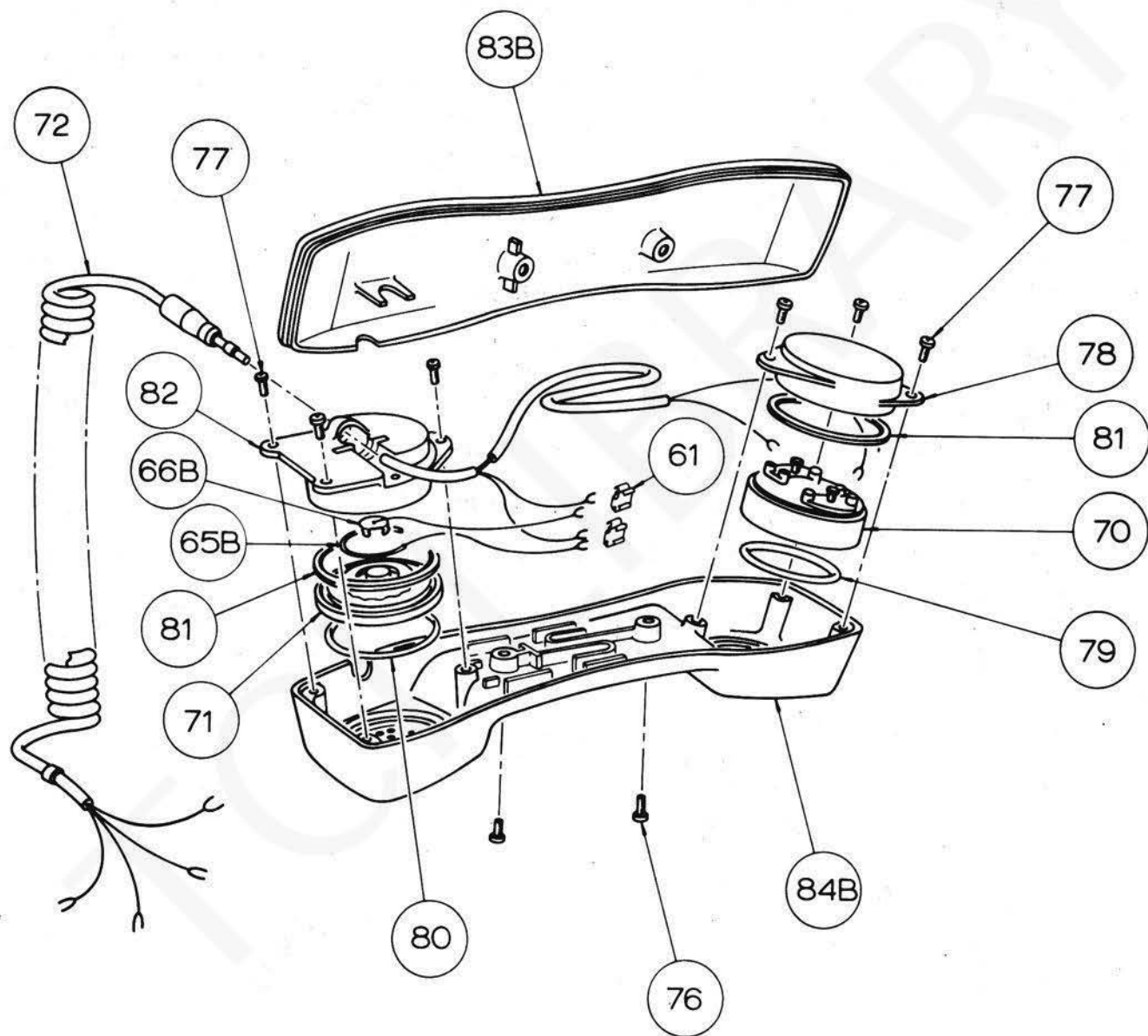

Fig. 15 – Chestphone Handset – Assembly of Parts (Table N)

TABLE N □
IDENTIFICATION OF PARTS – CHESTPHONE HANDSET ASSEMBLY

ITEM NO. (FIG. 15)	IDENTIFICATION		DESCRIPTION	QSK408A	QSK409A	QSK410A	QSK2408A	QSK2409A	QSK2410A
	NE PART NO.	DECO – TEL PART NO.							
61	P096B583	—	Connector	2	2	2	2	2	2
65B	P096B685	—	Assembly, Bracket and Lead	1	1	1	1	1	1
66B	P096B684	—	Assembly, Spider and Lead	1	1	1	1	1	1
70	NE-U1	—	Unit, Receiver	1	1	1	1	1	1
71	NE-T1	—	Unit, Transmitter	1	1	1	1	1	1
72	NE-H4QM-3	—	Cord, Handset (Black)		1			1	
	NE-H4QM-60	—	Cord, Handset, (Light Beige)	1		1	1		1
76	C0038008	7110	Screw, Fil HMS Slotted 0.138-32 (6-32) x 7/16 in. long.	2	2	2	2	2	2
77	C0038009	7109	Screw, PHMS, Slotted 0.112-40 (4-40) x 3/16 in. long.	6	6	6	6	6	6
78	C0038010	2032	Cover, Receiver	1	1	1	1	1	1
79	C0038011	7203	O-Ring, 1.237 in. ID x 0.103 in. dia.	1	1	1	1	1	1
80	C0038012	7202	O-Ring, 1.614 in. ID x 0.070 in. dia.	1	1	1	1	1	1
81	C0038013	2075	Gasket	2	2	2	2	2	2
82	C0038014	2031	Cover, Transmitter	1	1	1	1	1	1
83B	C0038015	2010-B	Cover Assembly, Handset		1			1	
	C0038016	2010-T	Cover Assembly, Handset (Tan)	1		1	1		1
84B	C0038017	2009-B	Base Assembly, Handset (Black)		1			1	
	C0038018	2009-T	Base Assembly, Handset (Tan)	1		1	1		1

5. ASSEMBLY OF PARTS

5.01 The instructions for substituting the field replaceable components in the QSK400-type telephone sets are contained in the following charts. The field replaceable components are listed in Table E.

Chart 2 Substitution of NE-M1A Ringer

Chart 3 Substitution of Dial

Chart 4 Substitution of Mounting Cord

Chart 5 Substitution of Handset Cord

Chart 1 Removal of Base Assembly

CHART 1 – REMOVAL OF BASE ASSEMBLY	
STEP	PROCEDURE
1	Remove bottom cover retaining screws (Fig. 16).
2	Remove handset and grommet from bottom cover.
3	Remove base assembly retaining screws.
4	Replace the base assembly by performing Steps 1 through 3 in the reverse order.
	<i>Caution: Do not overtighten the bottom cover retaining screws.</i>

CHART 2 – SUBSTITUTION OF NE-M1A RINGER	
STEP	PROCEDURE
1	Remove base assembly (Chart 1).
2	Remove ringer mounting screws.
3	Remove ringer leads (Table F).
4	Replace ringer by performing Steps 1 though 3 in the reverse order.

CHART 3 – SUBSTITUTION OF DIAL

STEP	PROCEDURE
1	Remove base assembly (Chart 1).
2	Remove dial mounting screws located on the back of the dial.
3	Remove dial leads from the dial for a QSK400-type telephone set or from the network for a QSK2400-type telephone set.
4	Replace dial by performing Steps 1 through 3 in the reverse order.

CHART 4 – SUBSTITUTION OF MOUNTING CORD

STEP	PROCEDURE
1	Remove base assembly (Chart 1).
2	Remove mounting cord leads from network.
3	Replace mounting cord by performing Steps 1 and 2 in the reverse order.

CHART 5 – SUBSTITUTION OF HANDSET CORD

STEP	PROCEDURE
CRADLEPHONE	
1	Remove base assembly (Chart 1).
2	Disconnect handset cord leads from network.
3	Remove the three screws holding the lower transmitter shell (Fig. 11 Item 80). Disconnect leads from QCM12A connectors.

CHART 5 (Cont) – SUBSTITUTION OF HANDSET CORD

STEP	PROCEDURE
4	Remove receiver cap and disconnect leads.
5	Remove screw from handle (Fig. 11 Item 82).
6	Remove screw from tube assembly (Fig. 11 Item 81).
7	Pull cord out of handset.
8	Replace handset cord by performing Steps 1 through 7 in the reverse order. The nuts (Fig. 11, Item 85) may be removed to facilitate the replacement of the handset cord.
CHESTPHONE	
9	Remove base assembly (Chart 1).
10	Disconnect handset cord leads from network.
11	Remove the two screws from the handset base assembly (Fig. 15 Item 76).
12	Disconnect transmitter leads from QCM12A connectors.
13	Remove the three screws from the receiver cover (Fig. 15 Item 77) and disconnect leads from receiver unit.
14	Pull cord out of transmitter cover.
15	Replace the cord by performing Steps 9 through 14 in the reverse order.

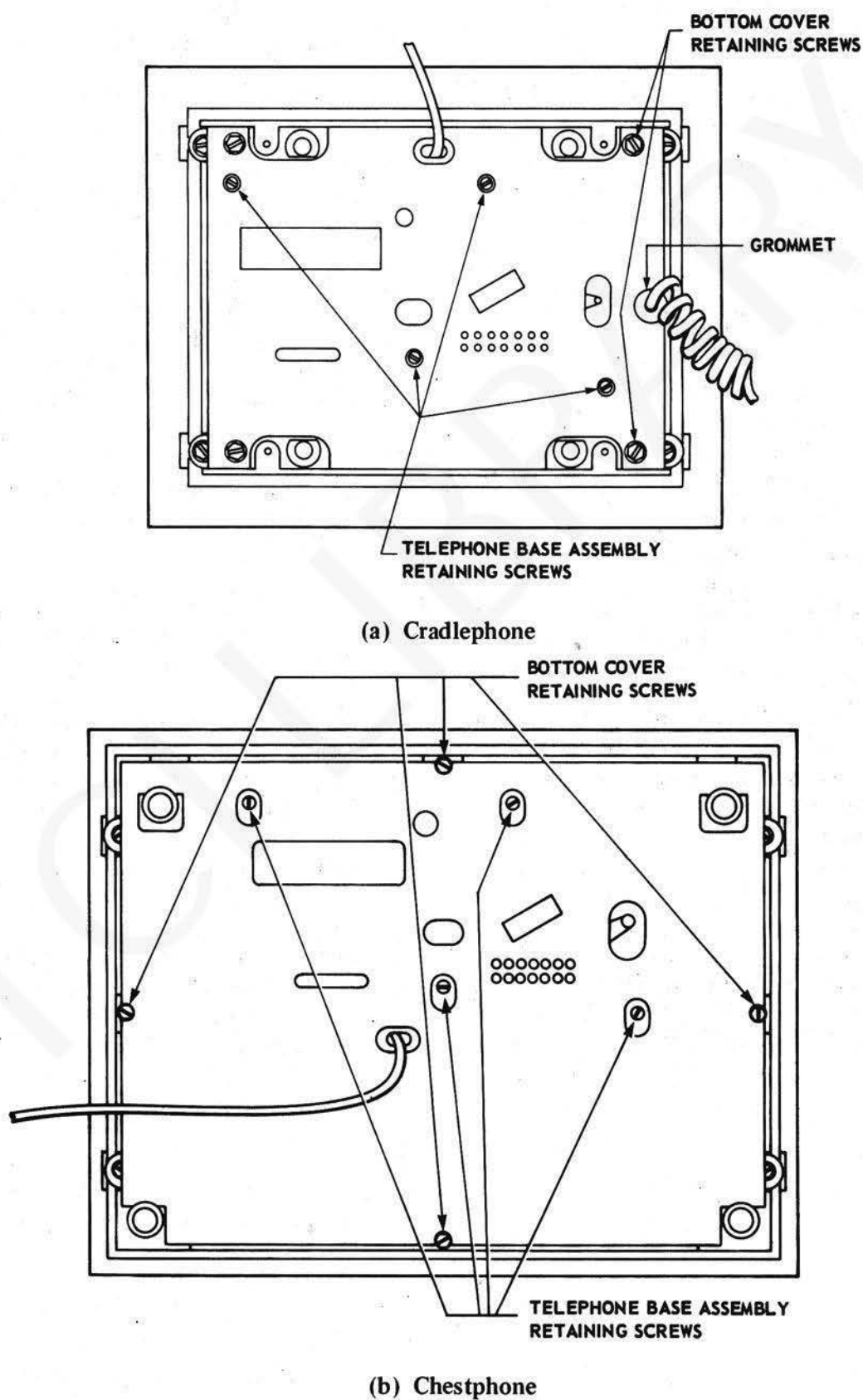

Fig. 16 — Bottom Views of QSK400-Type Telephone Set

6. PACKING INSTRUCTIONS

6.01 Antique/decorator telephone sets can be easily damaged in transit if they are not properly packaged. Before returning a disconnected set, carefully pack it in accordance with the following instructions.

(a) *Cradlephone*:—

- (i) Obtain the original packing material or ▲ order Packing Kit P5944.
- (ii) Place a large plastic bag completely over the telephone set housing.
- (iii) Place a plastic bag completely over the handset.
- (iv) Gather the mounting cord as shown in Fig. 17, place the cord and the spade tips in a plastic bag and secure with an elastic band. Lead the cord up at the center rear of the set and place it on top of the set housing.
- (v) Place the housing and handset in their respective cavities in the foam inserts, arranging the handset cord as shown. Make certain that the corner of the insert is broken off as shown.
- (vi) Enter the complete assembly into the carton.
- (vii) Ensure that the handset cord hangs loosely in its slot in the foam insert and is not caught underneath the insert or the set.

- (viii) Ensure that the mounting cord is not caught under either insert.

(b) *Chestphone*:—

- (i) Obtain the original packing material or ▲ order Packing Kit P5943.
- (ii) Place the handset on-hook, place padding over the handset and close the chest cover. The padding should be just thick enough to prevent the handset from moving when the chest cover is closed.
- (iii) Gather the mounting cord as shown in Fig. 18, place the cord and the spade tips in a plastic bag and secure with an elastic band.
- (iv) Place a large plastic bag completely over the chest and mounting cord. Position the mounting cord under the chest.
- (v) Place a foam insert at each end of the chest. Note that the inserts have a cutout on the bottom to accommodate the chest feet.
- (vi) Enter the complete assembly into the carton.
- (vii) Ensure that the mounting cord is positioned under the chest and is not caught between the inserts and the chest or the carton.

▲ Bell Canada only

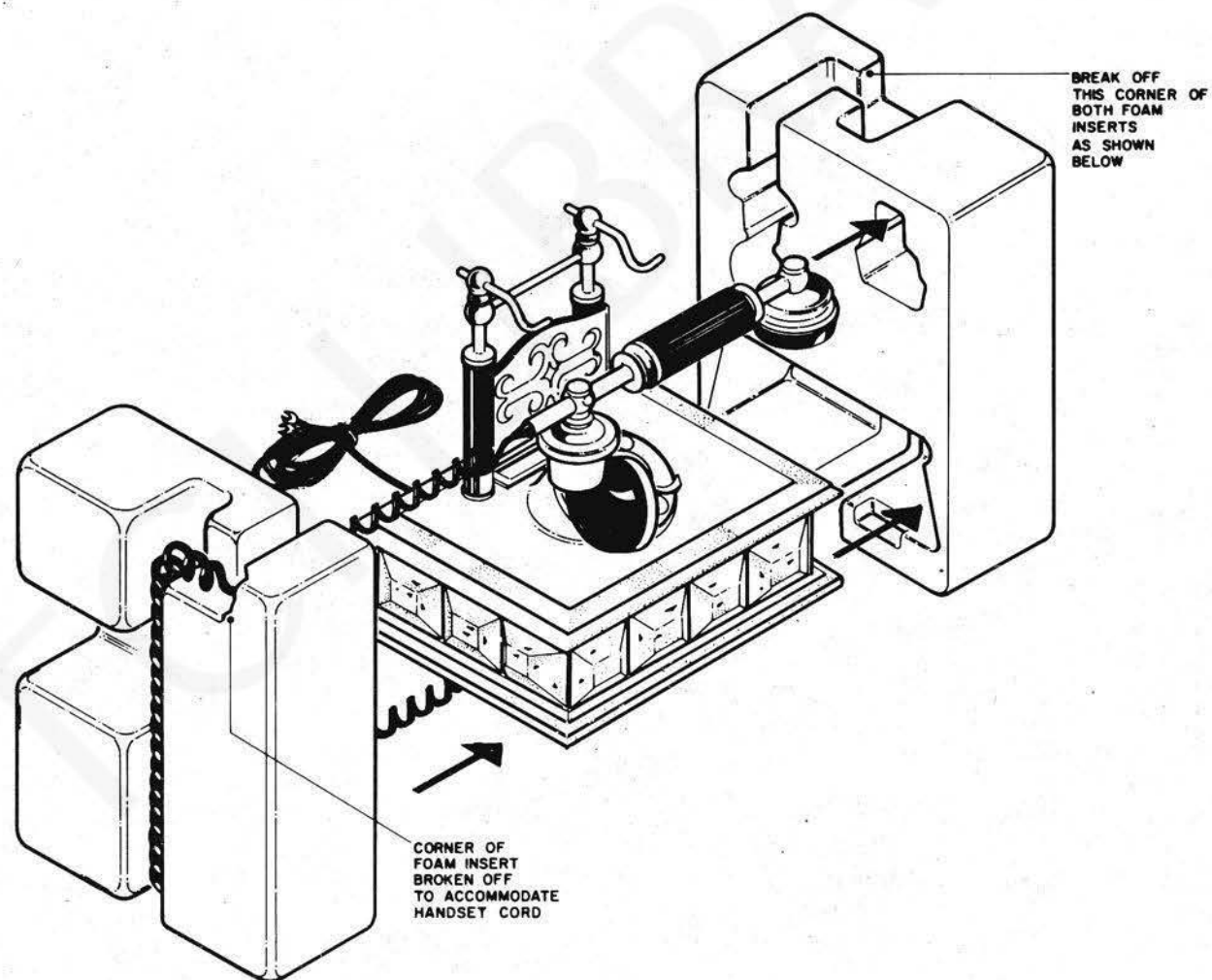

Fig. 17 — Cradlephone Packing Instructions

TCI Library: www.telephonecollectors.info

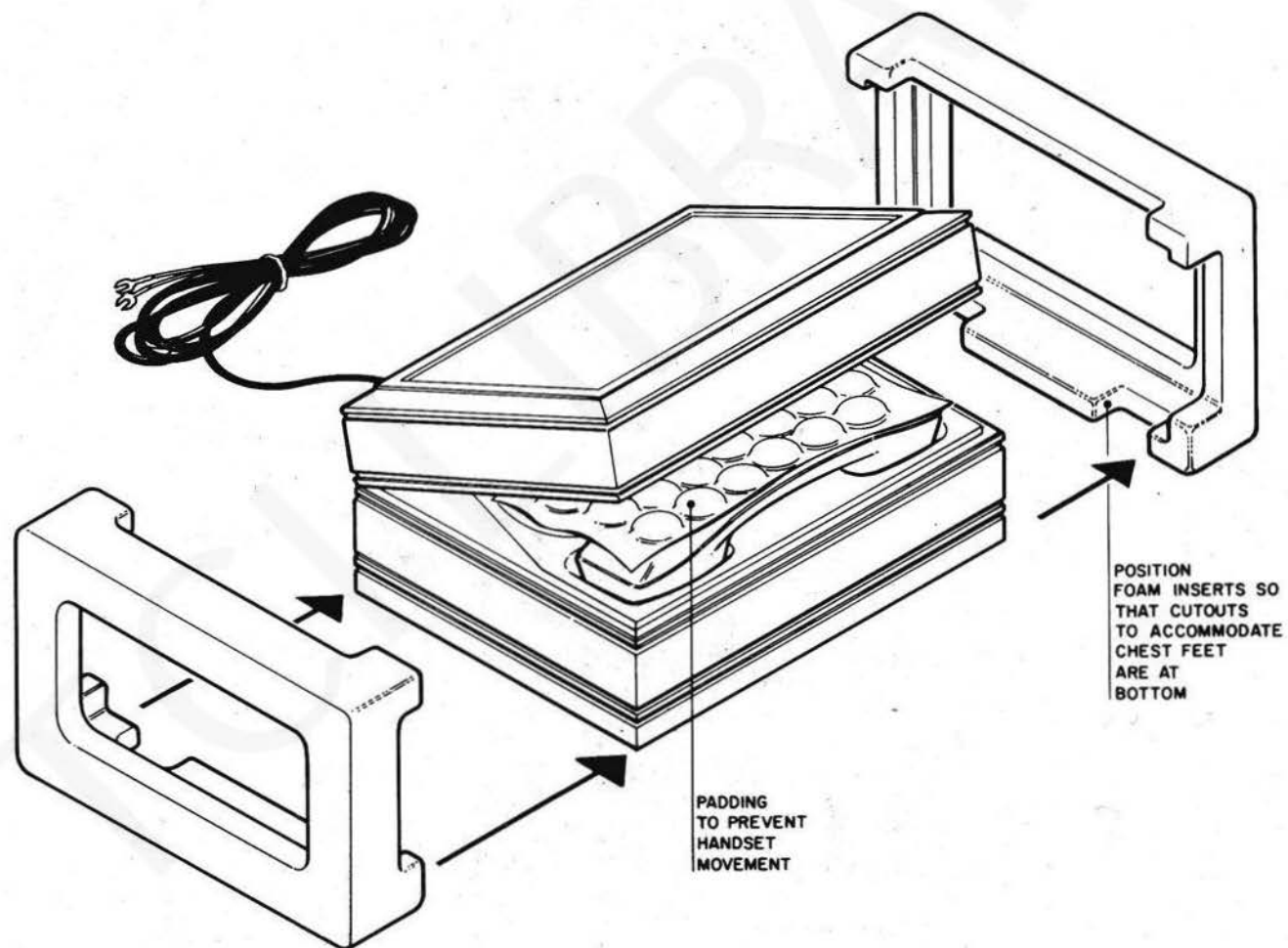

Fig. 18 – Chestphone Packing Instructions